



*jordan fishwick*

Macclesfield Road Whaley Bridge





## Macclesfield Road Whaley Bridge SK23 7DG

£235,000



### The Property

Set back from the road and boasting off road parking and delightful paved cottage gardens, a beautiful stone built mid-terraced property of character. Full of charm and ready to walk into, this outstanding two bedroom home is worth of an inspection. Oak doors and Iron latches, pvc double glazed windows, composite external doors and gas central heating. Comprising: entrance hall, living room open to a dining kitchen, understairs storage with plumbing for a utility area, two first floor bedrooms (master with fitted wardrobes) and a bathroom with contemporary white suite. Viewing recommended.





- Immaculately Presented
- Set back from the Road
- Front Paved Garden and Rear Paved Yard
- Off Road Parking
- Two Bedrooms
- Pvc Double Glazing and Gas Central Heating
- Popular Location
- Open Plan Ground Floor
- Great First Time Buy

**Postcode** SK23 7DG  
**EPC Rating** C  
**Local Authority** High Peak  
**Council Tax** B

Energy Efficiency Rating		
	Current	Potential
Very energy efficient - lower running costs		
(92 plus) A		91
(81-91) B		
(69-80) C	72	
(55-68) D		
(39-54) E		
(21-38) F		
(1-20) G		
Not energy efficient - higher running costs		
England & Wales		EU Directive 2002/91/EC



GROUND FLOOR

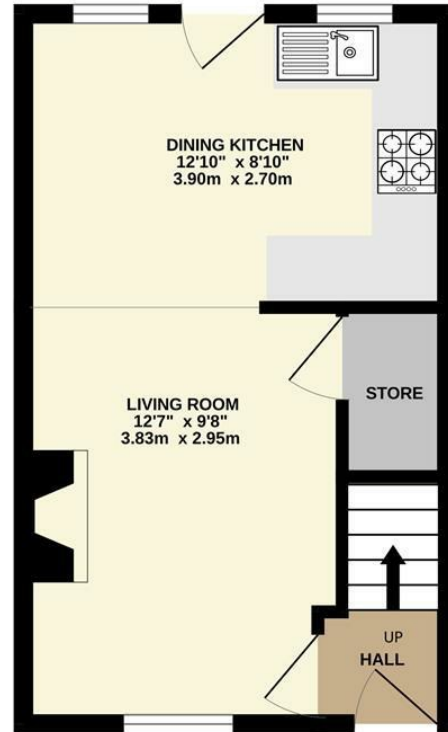

1ST FLOOR

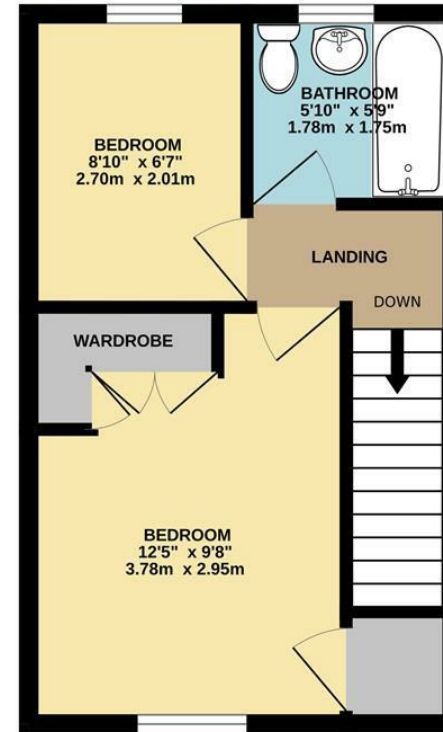

Whilst every attempt has been made to ensure the accuracy of the floorplan contained here, measurements of doors, windows, rooms and any other items are approximate and no responsibility is taken for any error, omission or mis-statement. This plan is for illustrative purposes only and should be used as such by any prospective purchaser. The services, systems and appliances shown have not been tested and no guarantee as to their operability or efficiency can be given.  
Made with Metropix ©2025



These particulars are believed to be accurate but they are not guaranteed and do not form a contract. Neither Jordan Fishwick nor the vendor or lessor accept any responsibility in respect of these particulars, which are not intended to be statements or representations of fact and any intending purchaser or lessee must satisfy himself by inspection or otherwise as to the correctness of each of the statements contained in these particulars. Any floorplans on this brochure are for illustrative purposes only and are not necessarily to scale.

Offices at: Chorlton, Didsbury, Disley, Hale, Glossop, Macclesfield, Manchester Deansgate, Manchester Whitworth Street, New Mills, Sale, Wilmslow and Withington

14 Market St, Disley, Cheshire, Stockport SK12 2AA

01663 767878

disley@jordanfishwick.co.uk

www.jordanfishwick.co.uk